



Newton North High School

Project Areas by function / Current Construction Activity – 5/22/09

Site work – General Items:

Started granite curb installation – north lot
Grading work at tennis court area

Pool/Small gym (B) –

Concrete foundations and steel erection is complete
Concrete floors - level 1 and 2 complete
Plumbing roof drainage piping – ongoing – 95% complete
Underground plumbing – ongoing – 20% complete
Fireproof paint at structural steel – ongoing- 80% complete
Exterior Masonry – ongoing – 20%
Permanent roof to start 6/1/09 +/-

Academic (C)

Concrete floors: All levels - complete.
Interior spray on fireproofing – level 2 & 3 & 4 – completed. Ground level – 80% complete – completion will occur subsequent to low roofing installation
Rough Mechanical/plumbing/ ductwork/electrical installation- Level 4 – 90% complete, Level 3 – 88% complete, Level 2 – 80% complete, Level 1 – 30 % complete.
Interior metal studs – started on level 2 on 5/18/09.
Interior Masonry – level 4 – 98% complete, level's 2 and 3 – 98% complete. Ground level 95% complete
Exterior Masonry – ongoing - 92% complete
Exterior framing, sheathing – 99% complete – exterior waterproofing ongoing – 90% complete
Permanent Roof Insulation work (except at low roof) – 100% complete.
Stair #5 - complete

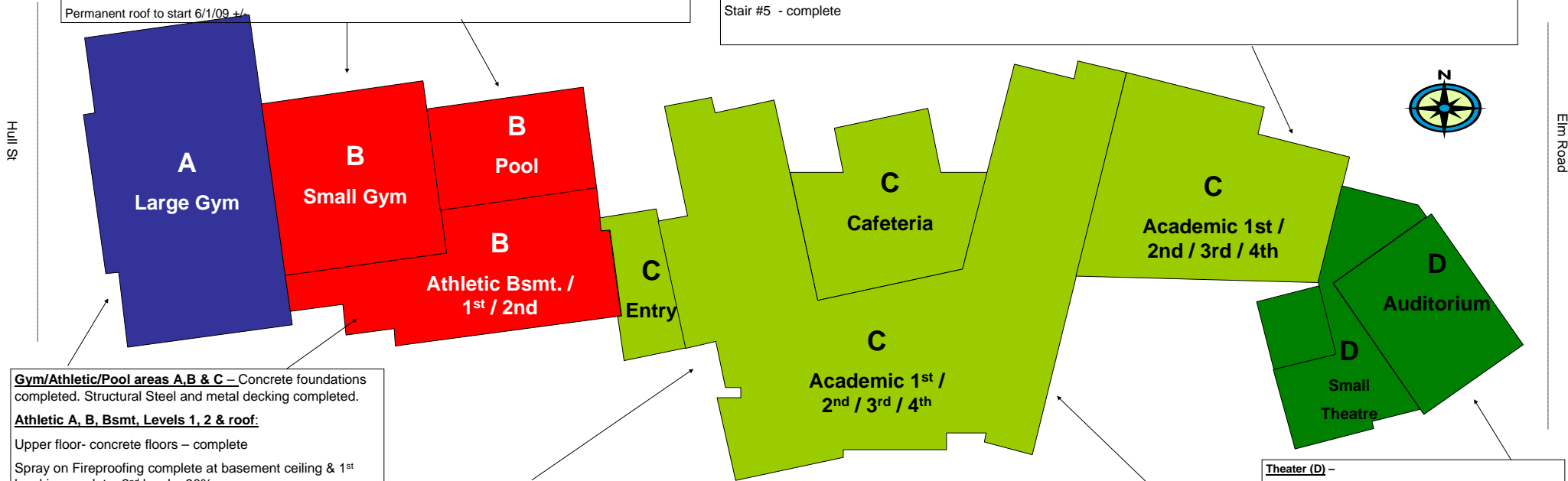

Gym/Athletic/Pool areas A,B & C – Concrete foundations completed. Structural Steel and metal decking completed.

Athletic A, B, Bsmt, Levels 1, 2 & roof:

Upper floor- concrete floors – complete
Spray on Fireproofing complete at basement ceiling & 1st level is complete, 2nd level – 90%
Plumbing rough in piping complete at basement locker rooms – 100% complete
Interior masonry – level 1- ongoing- 88 % complete, basement – ongoing – 70%. Level 2- will start on 5/26/09 +/-.
Roof parapet framing ongoing– 95%
Wall framing and sheathing ongoing – 95%
Window flashings/Exterior vapor barrier – ongoing – 15%
Stair #1 – started – 60% complete
Permanent roof insulation installation – Athletic “B” roof – completed week of 5/11/09, Athletic A – material delivered – install to start 5/26..
Elevator A – ongoing – building entrances

Academic (C) / Cafeteria (C):

Rough Mechanical/plumbing/ ductwork/electrical installation: ongoing: level 4- 99% complete. Level 3 -98% complete, Level 2 – 98% complete, Level 1 -90% complete. Continuance of level 1 contingent on cafeteria roof installation.
Exterior framing, sheathing – ongoing – 98% complete / Exterior flashings and waterproof barrier ongoing – 96% complete.
Interior metal stud framing – 94% complete. 3rd floor ready for drywall installation - start contingent on window installation in advance
Window delivery/installing – ongoing – installation at south elevations started 5/4/09
Interior masonry partitions – ongoing – 98% complete.
Exterior Masonry – Brick work started week of 2/2/09 – ongoing – 95% complete
Permanent roof insulation / Temporary roof – 100% of main complete – permanent roofing to be installed mid June 2009.
Culinary Arts – walk in coolers being delivered week of 5/22/09 +/- . Cooking fume hoods installed week of 5/18/09
Elevator B – ongoing – elevator platform complete – elevator entrances – ongoing.
Stair 4 - Steel and landing metal deck ongoing.

Theater (D) –

Perimeter concrete foundations and structural steel and small theater floor concrete - complete
Miscellaneous concrete Control room, stage and orchestra pit walls complete 100%. Second floor concrete complete – orchestra pit floor slab complete, stage floor concrete to be installed 5/29.
Exterior Masonry at large theater perimeter – started week of 5/18. Other exterior masonry is near complete at small theater
Underground piping work - complete.
Permanent roofing @ small theater – temporary roof installed
Fireproofing paint @ structural steel– ongoing– 100% complete. Spray on Fireproofing awaiting roof installation
HVAC equipment (chiller) is in place.
Masonry - Exterior – started 4/13 – ongoing – 30% complete. Masonry – Interior- ongoing – 25% complete
Rooftop HVAC Units – will be set in place 5/29/09.